



# WELCOME TO VALLEY RIVER INN

## GUEST ROOM HIGHLIGHTS

- 259 incredibly spacious rooms and suites
- Private patios or balconies available
- Designer bath amenities
- In-room workstation, sitting area, flat screen TV
- ADA accessible options

## DINING

- SweetWaters on the River: serving breakfast, lunch, dinner
- Outdoor patio with spectacular river views
- Wine room and private dining room

Valley River Inn brings the best of Eugene, Oregon to your doorstep. A perfect destination for your unforgettable experiences in Eugene, including meetings, weddings, and social events. Offering ample parking, easy access to the highway, the University of Oregon, and Downtown Eugene.

## ACTIVITIES

- Heated outdoor pool & 24/7 fitness center
- 12 miles of riverfront hiking/biking paths
- Wine tasting on-site; local breweries nearby
- Bicycle rentals available

## LOCATION

- Overlooking the Willamette River
- Steps from Valley River Center mall
- 3 Miles to University of Oregon & Downtown Eugene
- 15 minutes from Eugene Airport
- Complimentary shuttle to airport



To Valley River Center

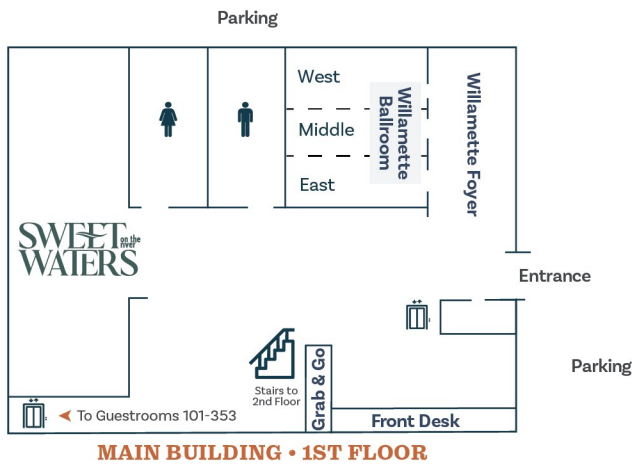

**MAIN BUILDING • 1ST FLOOR**

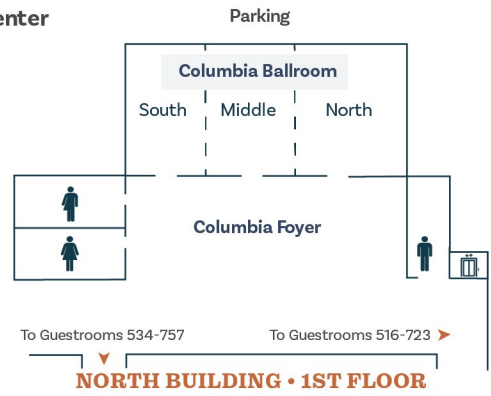

**NORTH BUILDING • 1ST FLOOR**

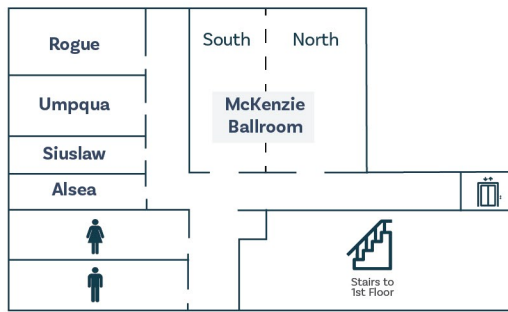

**MAIN BUILDING • 2ND FLOOR**

## MEETINGS & EVENTS

- Over 15,000 sq. ft. of meeting and event space
- Some spaces with natural lighting and river views
- Custom on-site catering and A/V packages
- 8 distinctive venues
- 500 person banquet hall capacity
- 800 person reception capacity

MEETING ROOMS	TOTAL SQ FT	ROOM SIZE	ROUNDS	BANQUET	CLASSROOM	THEATRE	RECEPTION	U-SHAPE	HOLLOW SQUARE
<b>WILLAMETTE (ALL)</b>	6,113	113' x 54' 10" x 15' 10"	570(10)	550	300(4), 225(3)	780	N/A	N/A	N/A
East	1,569	29'x54' 10"	150(10)	150	60(4), 45(3)	150	40	40	44
Middle	1,569	29'x54' 10"	150(10)	150	60(4), 45(3)	150	40	40	44
West	2,975	54' x 54' 10"	270(10)	240	180(4), 135(3)	450	56	48	64
<b>COLUMBIA (ALL)</b>	3,276	84' x 39' x 9' 9'	240(10)	250	180(4), 135(3)	300	N/A	N/A	N/A
North	1,287	33' x 39'	90(10)	80	72(4) , 54(3)	112	40	30	48
Middle	848	22' x 39'	70(10)	60	48(4), 36(3)	80	30	22	40
South	1,131	29' x 39'	80(10)	80	60(4), 45(3)	80	30	25	40
<b>MCKENZIE (ALL)</b>	3,475	58' 9" x 59' x 14'	270(10)	250, 200	208(4), 156(3)	400	N/A	N/A	N/A
North	2,118	35' 9" x 59'	160(10)	150, 120	120(4), 90(3)	260	44	48	45
South	1,357	23' x 59'	90(10)	90, 72	80(4), 60(3)	140	34	34	30
<b>ROGUE</b>	900	30' x 30'	70(10)	50	48(4), 36(3)	90	30	30	40
<b>UMPQUA</b>	660	30' x 22'	20(10)	40	36(4), 27(3)	60	24	22	30
<b>ALSEA</b>	330	22" x 15'	20(10)	18	16(4), 12(3)	22	12	20	16
<b>SIUSLAW</b>	330	22' x 15'	20(10)	10	16(3), 12(3)	22	12	20	16
<b>SANTIAM</b>	330	22' x 15"	2(10)	10	16(3), 12(3)	22	12	20	16